



# DIY Closet Installation

510 E Barnard St, Ste 38  
West Chester, PA 19382

610.431.3500 Ext. 105  
Michael@DiplomatClosetDesign.com

[DiplomatClosetDesign.com](http://DiplomatClosetDesign.com)

# What to Know Before You Start

## How to Read your Material Labels:

- ✓ Each component will come labeled with component specific information
- ✓ Pro Tip: Do not remove any labels until your built-in is fully installed!

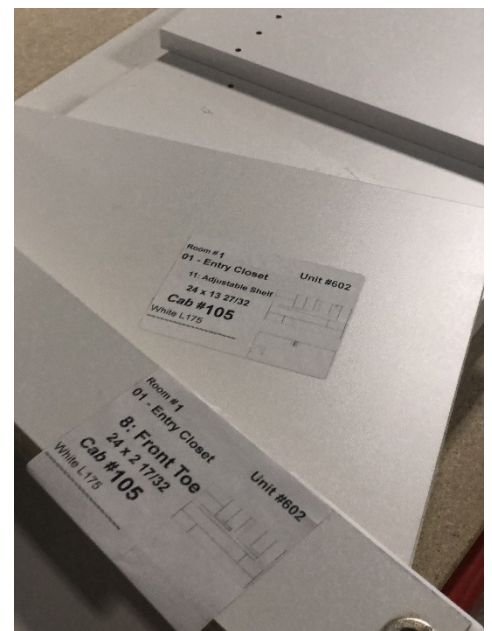
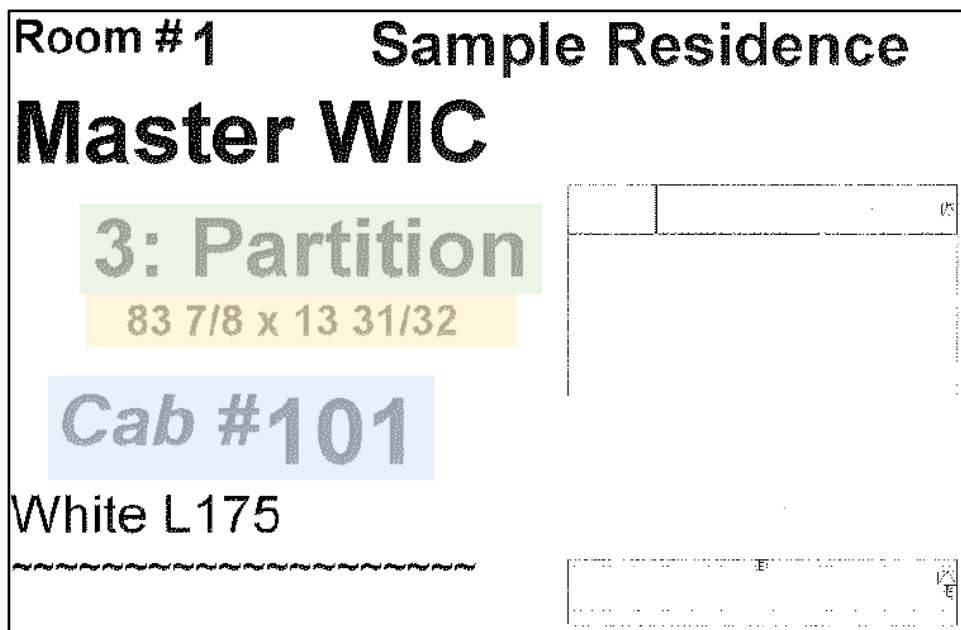

### Name of Component Piece

Examples:

- Partition (Vertical Panel)
- Adjustable Shelf
- Front Toe
- Nailer
- Fixed Shelf

### Size of the Component Part

- Length x Width

### Component Part Number

This number coordinates with the **drawing set** associated with your built-in design. A shelf unit with five shelves would have the same part number for every shelf falling in the same tower.

The part numbers are in numerical order following the drawing set.

**Pro Tip:** Set yourself up for an easy install by organizing and sorting all the component pieces in numerical order by part numbers for a systematic install.

**Pro Tip:** Easily remove any leftover label residue with a citrus based cleaner.

# What to Know Before You Start

## How to Read your Drawing Set:

- ✓ Each unit is numbered, starting with #101
- ✓ Review your plan view and elevation diagrams to accurately organize, sort, and count to make sure all components are correct for install.

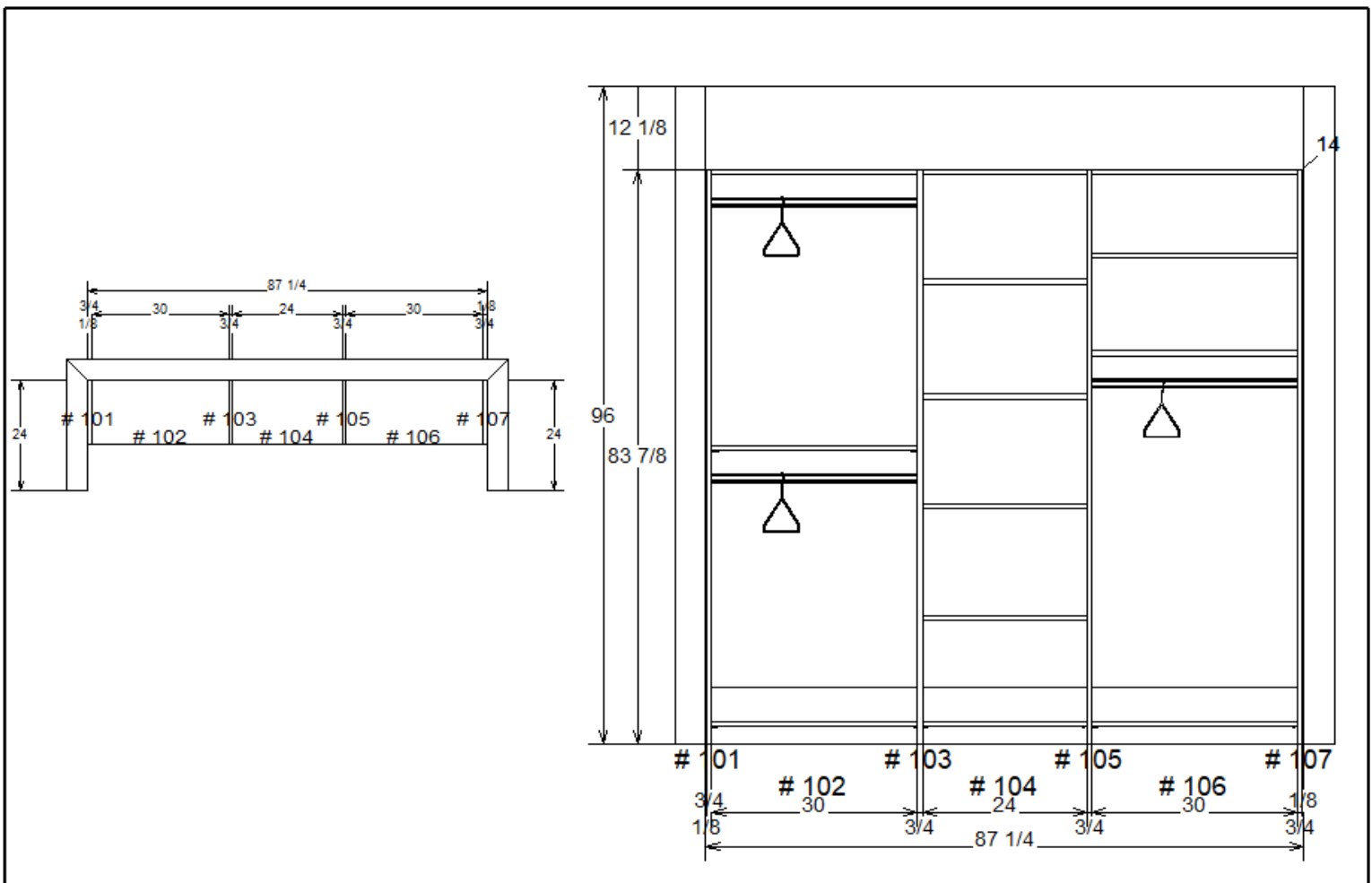

**DIPLOMAT  
CLOSET DESIGN**  
510 E. BARNARD ST | STE 2B | WEST CHESTER, PA  
630.431.3500 | DiplomatClosetDesign.com

☐ Approved

☐ Rejected (As Noted)

Name: Sample Residence

Address: 123 Main Street

City: West Chester

State: PA

Job #: Closet Pro Order

Master Closet

Date: 12.25.2021

DWG. By:

AZ

Sheet #

1

# Tools Needed for Installation

- ✓ Ratchet
- ✓ Combo Square
- ✓ Hammer
- ✓ Mini Pry Bar
- ✓ 5MM Drill Bit
- ✓ Pencil
- ✓ Tape Measure
- ✓ Phillips Head Screwdriver
- ✓ Rubber Mallet
- ✓ Stud Finder
- ✓ Drill and Impact Gun
- ✓ Double-sided Tape
- ✓ Assorted Levels
- ✓ Blue Tape
- ✓ Clamps
- ✓ Snips





# DIY Installation

## First Steps for Wall Mount Installation:

- ✓ Tools Needed: Level, Stud Finder, and Impact Drill
- ✓ Included Hardware Needed: Metal Hang Rail, White Rail Cover, and 2" screws.
- ✓ Determine the finished height of your built-in and then subtract 2" to mark your line (The brackets fall 2" below the finished top shelf)
- ✓ Use the stud finder to mark all the studs. Secure the metal hang rail with the 2" screws into the marked studs
- ✓ Cover the metal hang rail with the white rail cover



# DIY Installation

## Wall Mount Installation Guide:

- ✓ Install the partition brackets – adjust as needed
- ✓ Hang all the partitions on the secured hang rail
- ✓ Insert the single-sided dowels on the end partitions and the two-sided dowels on the intermediate partitions
- ✓ Drop in the top fixed shelf of each unit and then the lower fixed shelves. Use the phillips head screwdriver to fully tighten the cams
- ✓ Once frame is built – use your level to straighten everything out. Adjust brackets to fully level the unit if necessary
- ✓ Anchor the unit once it is level with the provided L-brackets
- ✓ **Pro Tips:**
  - Be sure to tighten the cams a full 180 degrees
  - Leave out the fixed shelf that sits above the drawers for now
  - Be sure all L-brackets are secured into a stud



**Click Here to  
Watch Now!**

# DIY Installation

## Final Touches for Installation:

- ✓ Install one piece of the 14" drawer slide onto the drawer boxes
- ✓ Install the second piece of the 14" drawer slides into the partition's pre-drilled slide holes with the provided euro screws
- ✓ Insert the drawer boxes by lining up the slides and pushing in until you hear two clicks (*One for either side*)
- ✓ Install middle fixed shelf above drawer boxes as shown in video below
- ✓ Use double sided tape to line up and secure the drawer faces to the drawer boxes
- ✓ Attach the drawer face side with the pre-drilled screw holes against the drawer box
- ✓ Use 1" face screws to secure drawer face to drawer box
- ✓ Use blue sided tape as a guide to mark the drawer faces for the hardware hole locations
- ✓ Breakaway screws provided for hardware selection
- ✓ **Pro Tip:**
  - Use an L-Bracket as a guide to separate drawer faces

