

A photograph of a modern, white, custom closet system. The closet features built-in drawers, shelves, and a countertop. On the left, there are two orange Louis Vuitton boxes. On the right, there are two more orange boxes. A glass tray with a red box, a white candle, and a ring is on the countertop. The text "Product Components and Included Hardware Guide" is overlaid in a handwritten style.

Product Components and Included Hardware Guide

510 E Barnard St, Ste 38
West Chester, PA 19382

610.431.3500 Ext. 105
Michael@DiplomatClosetDesign.com

DiplomatClosetDesign.com

Product Components Guide

Floor Mount Hanging Unit

Floor Mount Vertical Panel:

- ✓ One Finished Edge (Face Forward)



Cam Shelf:

- ✓ One Finished Edge (Face Forward)
- ✓ Four Cams



Adjustable Shelf:

- ✓ One Finished Edge (Face Forward)
- ✓ Four Shelf Pins



Chrome Oval Hanging Rod:

- ✓ Two Rod Cups

Cam Shelves:

- ✓ One Finished Edge (Face Forward)
- ✓ Four Cams

Recessed Toe Kick:

- ✓ Unfinished Edges
- ✓ Two Cams
- ✓ 2.5" H

Nailer:

- ✓ One Finished Edge (Face Upward)
- ✓ This board should fit snugly with no hardware above the bottom shelf
- ✓ No cams
- ✓ 5" H
- ✓ Pro Tip: Use Caulk on the back to stick to wall

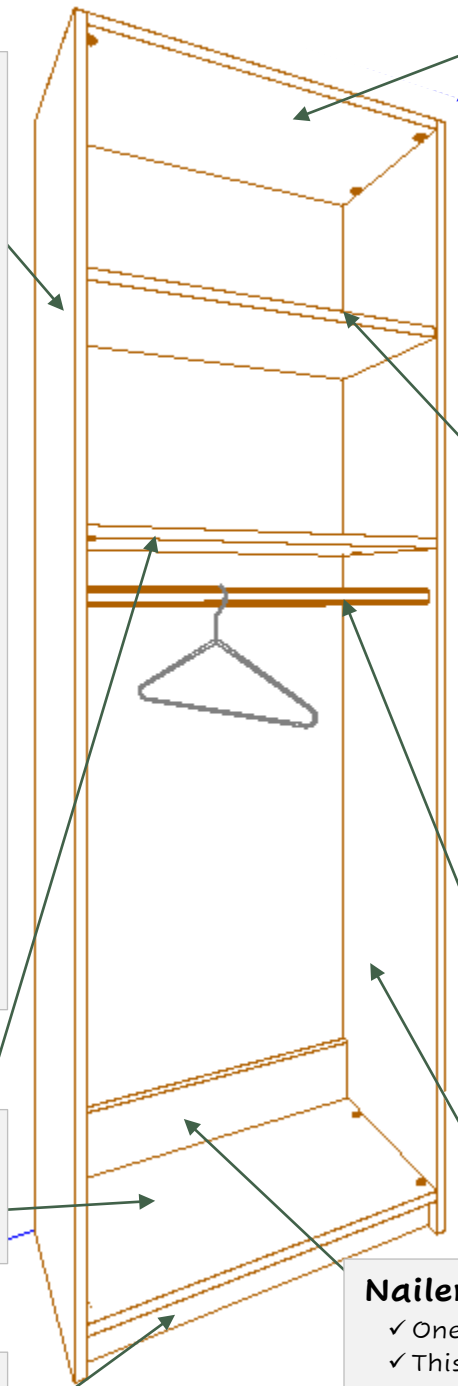

Product Components Guide

Wall Mount Hanging Unit

Left Vertical Wall Panel:

- ✓ Two Finished Edges
- ✓ Wall Bracket Notch

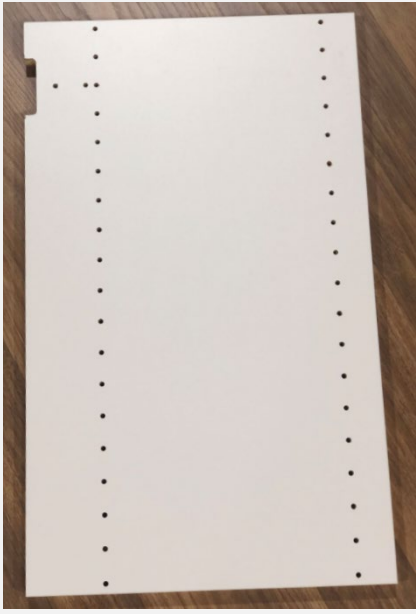

Cam Shelf:

- ✓ One Finished Edge (Face Forward)
- ✓ Four Cams



Cam Shelf:

- ✓ One Finished Edge (Face Forward)
- ✓ Four Cams

Bracket and Bracket Cover:

- ✓ Metal Adjustable Bracket
- ✓ White Bracket Cover

Rail and Rail Cover:

- ✓ Metal Rail for Securing to Wall
- ✓ White Rail Cover

Right Vertical Wall Panel:

- ✓ Two Finished Edges
- ✓ Wall Bracket Notch

Adjustable Shelf:

- ✓ One Finished Edge (Face Forward)
- ✓ Four Shelf Pins



Chrome Oval Hanging Rod:

- ✓ Two Rod Cups

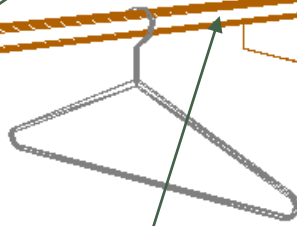

Product Components Guide

Drawer Tower Unit

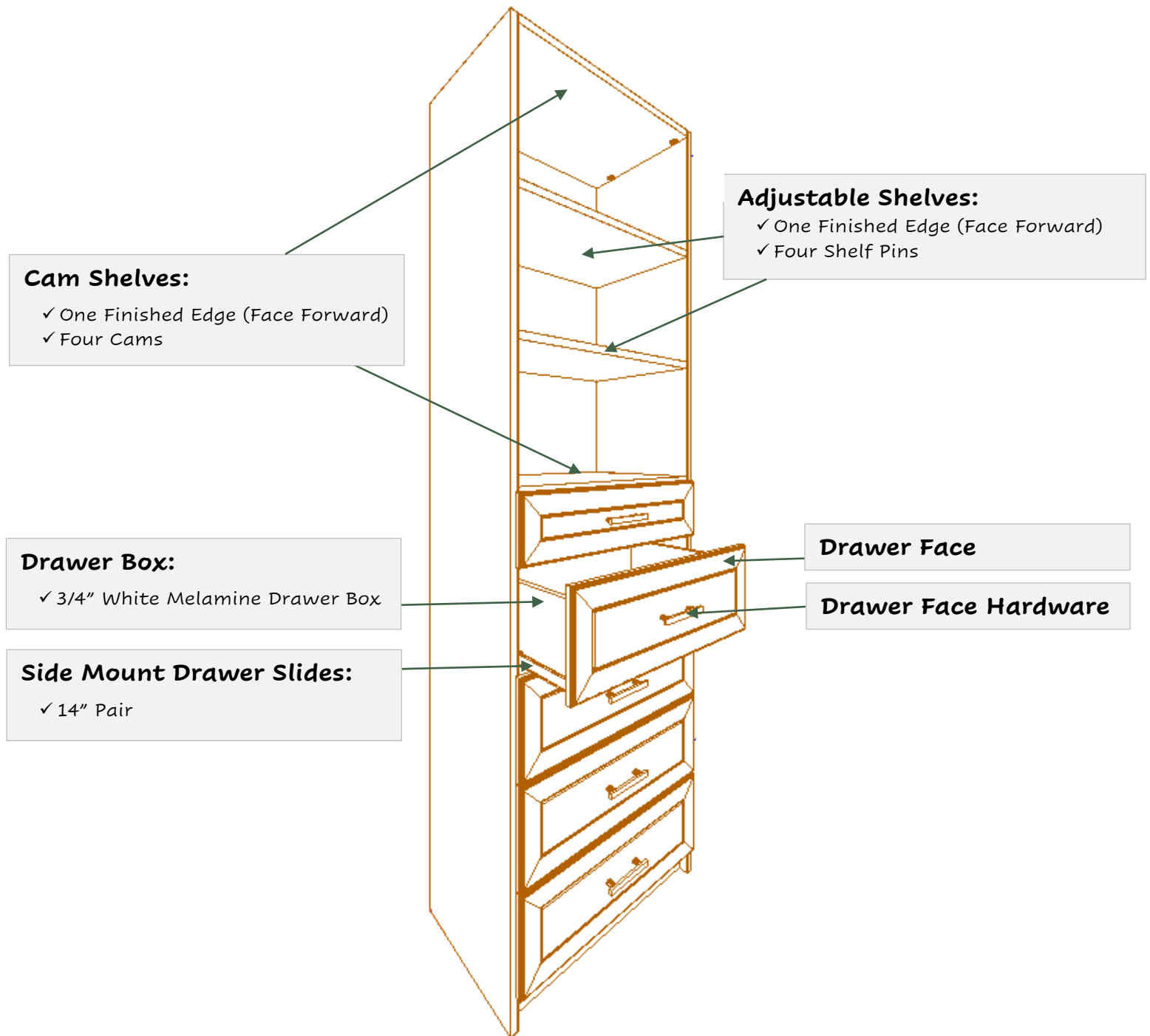

Included Hardware Guide

Rail and Rail Cover:

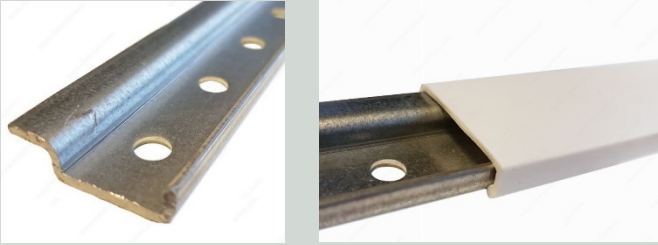

Shelf Pin:



Metal Hanging Bracket & Bracket Cover:



Euro-Screws:



Chrome Oval Hanging Rod & Rod Cups:



3/4" Screws:

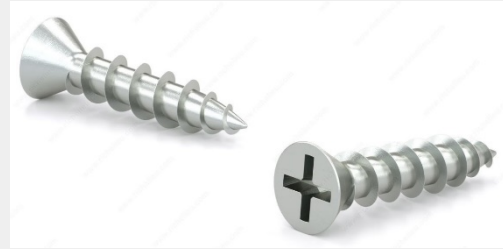

One-Sided Dowel:

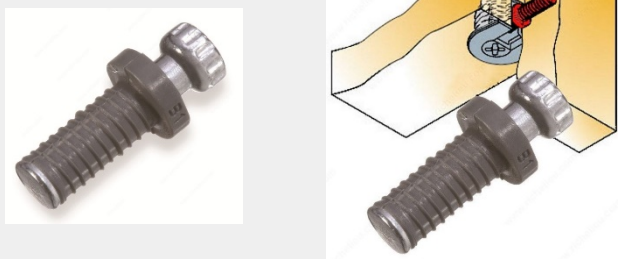

2" Screws:



Two-Sided Dowel:

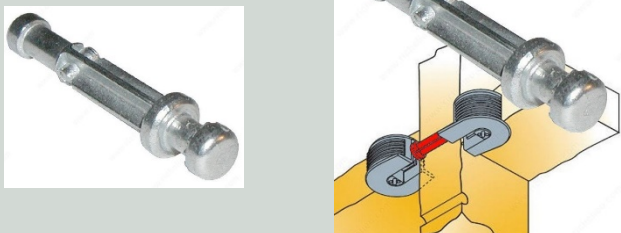

Drawer Face Screws:

If Design Includes Drawers



Included Hardware Guide, cont'd

Mending Plate:



L-Bracket:



Breakaway Screws:

If Design Includes Drawers



14" Side Mount Drawer Slides:

If Design Includes Drawers



Drawer Face Hardware:

If Design Includes Drawers

C-Pull Handle:



Half Moon Handle:



Bar Pull Handle:



Knob:



Optional Touch Up Kits Available:

Contact Us to Order at 610-431-3500 Ext 105
Or email Michael@DiplomatClosetDesign.com

- ✓ Screw Hole Sticker Covers
- ✓ Touch Up Putty Stick
- ✓ Shelf Pin Plugs
- ✓ White 3 in 1 Repair Stick

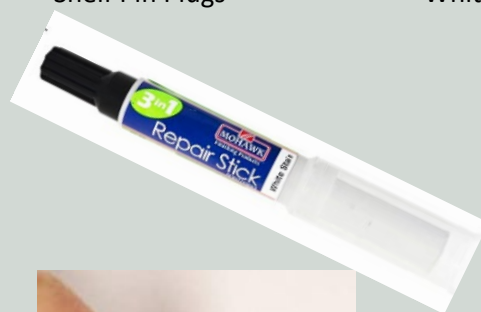

Diplomat Closet Design proudly sources our hardware from Richelieu

Photo Credit: Richelieu.com

